

# Vacuum Series Vacuum Pad Standard Type

## VPA

Fixed type  
Vacuum Port  
top  
CAD

Dimensions for pad  $\phi 2\sim\phi 8$

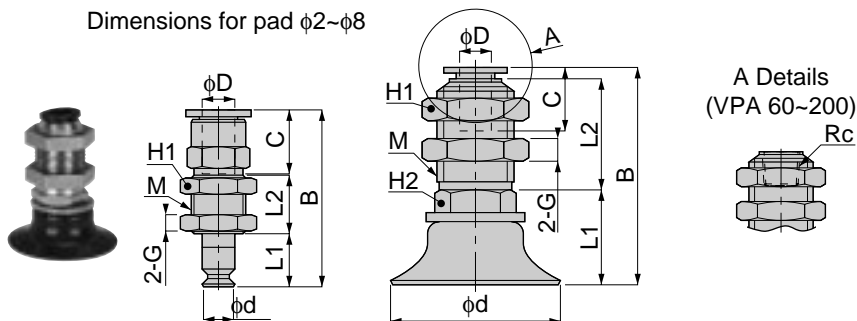

unit:mm

Model	Tube dia. $\phi D$	Pad dia. $\phi d$	Rc	M	B	L1	L2	C	H1	H2	G	Mass (g)
VPA 2R□-4J	4	2	-	M6×0.75	28	6	10	11	10	-	2	5
VPA 3R□-4J	4	3	-	M6×0.75	28	6	10	11	10	-	2	5
VPA 4R□-4J	4	4	-	M6×0.75	28	6	10	11	10	-	2	5
VPA 6R□-6J	6	6	-	M10×1	32	9.5	12	11.5	12	-	3	12
VPA 8R□-6J	6	8	-	M10×1	31	8	12	11.5	12	-	3	12
VPA 10R□-6J	6	10	-	M12×1	34	12	18	11.5	14	12	4	10.5
VPA 15R(A)□-6J	6	15	-	M12×1	35(36)	13(14)	18	11.5	17	12	4	11
VPA 20R(A)□-6J	6	20	-	M14×1	37.5(38.5)	15.5(16.5)	22	11.5	17	14	4	35
VPA 25R(A)□-6J	6	25	-	M14×1	38.5(41.5)	16.5(17.5)	22	11.5	17	14	4	36
VPA 30R(A)□-6J	6	30	-	M14×1	38.5(41.5)	16.5(17.5)	22	11.5	17	14	4	37.5
VPA 40R(A)□-6J	6	40	-	M14×1	41.5(45)	19.5(23)	22	11.5	17	14	4	45.5
VPA 50R(A)□-6J	6	50	-	M14×1	42.5(45.5)	20.5(23.5)	22	11.5	17	14	4	52
VPA 60R(A)□-01	-	60	Rc1/8	M20×1	51	31	20	-	24	22	5	133
VPA 80R(A)□-01	-	80	Rc1/8	M20×1	53	33	20	-	24	22	5	222.5
VPA 100R□-01	-	100	Rc1/8	M20×1	55	35	20	-	24	22	5	316
VPA 150R□-02	-	150	Rc1/4	M24×2	95	65	30	-	30	27	10	942.5
VPA 200R□-02	-	200	Rc1/4	M24×2	100	70	30	-	30	27	10	1425



※ The dimension in ( ) is that for the deep pad.

※ Specify pad material inside □ in type.  
Pad materials are as follows;

code	pad material	pad size
N	Nitrile rubber	$\phi 2\sim\phi 200$ mm
S	Silicon rubber	$\phi 2\sim\phi 200$ mm
U	Urethane rubber	$\phi 2\sim\phi 200$ mm
F	Fluoric rubber	$\phi 2\sim\phi 200$ mm
SE	Antistatic rubber	$\phi 2\sim\phi 15$ mm
E	Antistatic rubber (low resistance type)	$\phi 2\sim\phi 50$ mm
G	NBR suited the Food Sanitation Act	$\phi 2\sim\phi 50$ mm



## VPA

Fixed type  
Vacuum Port  
top  
CAD

Dimensions for pad  $\phi 2\sim\phi 8$

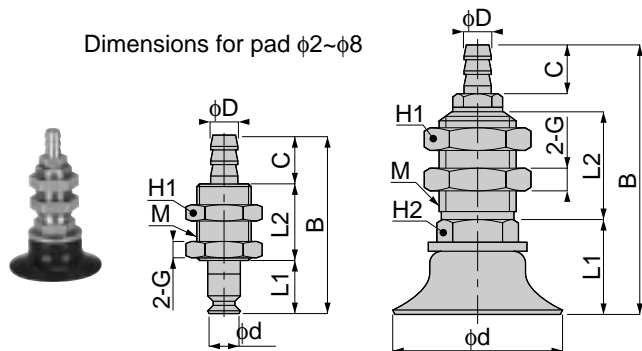

unit:mm

Model	Tube dia. $\phi D$	Pad dia. $\phi d$	M	B	L1	L2	C	H1	H2	G	Mass (g)
VPA 2R□-4B	2.5	2	M5×0.5	21	6	8	7	8	-	2	2.5
VPA 3R□-4B	2.5	3	M5×0.5	21	6	8	7	8	-	2	2.5
VPA 4R□-4B	2.5	4	M5×0.5	21	6	8	7	8	-	2	2.5
VPA 6R□-6B	4	6	M8×0.75	27.5	8.5	10.5	8.5	10	-	2	6
VPA 8R□-6B	4	8	M8×0.75	26	7	10.5	8.5	10	-	2	6
VPA 10R□-6B	4	10	M8×0.75	36.5	13	15	8.5	10	10	2	11
VPA 15R(A)□-6B	4	15	M8×0.75	37.5(38.5)	14(15)	15	8.5	10	10	2	11
VPA 20R(A)□-6B	4	20	M12×1	42.5(43.5)	16(17)	18	11.5	14	12	4	27.5
VPA 25R(A)□-6B	4	25	M12×1	43.5(44.5)	17(18)	18	11.5	14	12	4	28.5
VPA 30R(A)□-6B	4	30	M12×1	43.5(46.5)	17(20)	18	11.5	14	12	4	30
VPA 40R(A)□-6B	4	40	M12×1	46.5(50)	20(23.5)	18	11.5	14	12	4	37.5
VPA 50R(A)□-6B	4	50	M12×1	47.5(50.5)	21(24)	18	11.5	14	12	4	44.5



※ The dimension in ( ) is that for the deep pad.