

How to identify speed controller types

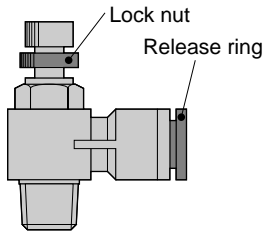

	Release ring Shape · Color	Plastic body Color	Lock nut color	
			Atype	Btype
Standard type	Circle · Black	Black	Silver	Black
Mini type	Oval · Black	Black	Silver	Black
Large flow type	Circle · Black	Black	Blue	—
SUS303 equiv. anti_corrosive type	Circle · Dark blue	Black	Silver	Black
Clean-room Ready type	Circle · Light blue	Light blue	Silver	Black

⚠ Detailed Safety Instructions

Before using the PISCO device, be sure to read the "Safety Instructions", "Common Safety Instructions for Products Listed in This Manual" on page 7 and "Common Safety Instructions for Controllers" on pages 43.

⚠ Warning

- Adjust the speed of the actuator by opening the needle gradually from the fully closed position. With the needle open, there are chances of the actuator flying out. Turn the needle clockwise to close or counterclockwise to open.
- Do not subject the product with a rotatable resin to forcible swinging or rotation. Otherwise the body may suffer damage or develop leakage.

⚠ Caution

- The Speed Controller is designed to tolerate some air flow at fully. Therefore do not use it for applications that permits no air flow.



Elbow

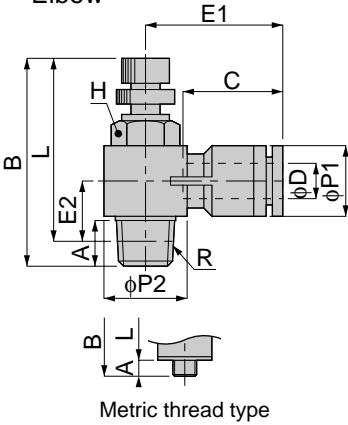

Metric thread type



Model	Tube dia. φD	R	A	B		L		φP1	φP2	C	E1	E2	H	Mass (g)
				max	min	max	min							
JSC 4-M5□(K)	4	M5×0.8	3	29.5	27	26.5	24	10	10	15	20	6.5	8	8.5
JSC 4-01□(K)		R1/8	8	40.5	34	36.5	30							
JSC 6-M5□(K)	6	M5×0.8	3	29.5	27	26.5	24	12.5	14.5	17	24	7.5	8	9.5
JSC 6-01□(K)		R1/8	8	40.5	34	36.5	30							
JSC 6-02□(K)		R1/4	11	47.5	41	41.5	35							
JSC 6-03□		R3/8	12	53.5	46.5	47	40							
JSC 8-01□(K)	8	R1/8	8	40.5	34	36.5	30	14.5	18.5	18.5	27	11.5	10	20
JSC 8-02□(K)		R1/4	11	47.5	41	41.5	35							
JSC 8-03□		R3/8	12	53.5	46.5	47	40							
JSC 8-04□		R1/2	15	59	51.5	51	43.5							
JSC 10-02□(K)	10	R1/4	11	47.5	41	41.5	35	18	22	20.5	31	14.5	14	40.5
JSC 10-03□		R3/8	12	53.5	46.5	47	40							
JSC 10-04□		R1/2	15	59	51.5	51	43.5							
JSC 12-03□	12	R3/8	12	53.5	46.5	47	40	21.5	28	23.5	37	18	19	71
JSC 12-04□		R1/2	15	59	51.5	51	43.5							
JSC 1/4-M5□(K)	1/4	M5×0.8	3	29.5	27	26.5	24	12.5	14.5	17	24	7.5	8	9.5
JSC 1/4-01□(K)		R1/8	8	40.5	34	36.5	30							
JSC 1/4-02□(K)		R1/4	11	47.5	41	41.5	35							
JSC 5/16-01□(K)	5/16	R1/8	8	40.5	34	36.5	30	14.5	18.5	18.5	27	11.5	10	20
JSC 5/16-02□(K)		R1/4	11	47.5	41	41.5	35							
JSC 5/16-03□		R3/8	12	53.5	46.5	47	40							
JSC 3/8-02□(K)	3/8	R1/4	11	47.5	41	41.5	35	18	18.5	20.5	31	14.5	14	40.5
JSC 3/8-03□		R3/8	12	53.5	46.5	47	40							

unit:mm

unit:inch

Model	Tube dia.φD inch(mm)	NPT	A	B		L		φP1	φP2	C	E1	E2	H	Weight (oz)
				MAX	MIN	MAX	MIN							
JSC 5/32-U10□(K)U	5/32(3.97)	10-32UNF	0.14	1.16	1.06	1.02	0.93	0.39	0.39	0.59	0.79	0.26	5/16	0.29
JSC 5/32-N1□(K)U	5/32(3.97)	NPT 1/8	0.31	1.59	1.34	1.44	1.18	0.39	0.57	0.59	0.85	0.41	7/16	0.61
JSC 3/16-U10□U	3/16(4.76)	10-32UNF	0.14	1.16	1.06	1.02	0.93	0.49	0.39	0.67	0.94	0.30	5/16	0.34
JSC 3/16-N1□U	3/16(4.76)	NPT 1/8	0.31	1.59	1.34	1.44	1.18	0.49	0.57	0.67	0.93	0.41	7/16	0.70
JSC 3/16-N2□U	3/16(4.76)	NPT 1/4	0.43	1.87	1.61	1.63	1.38	0.49	0.73	0.67	1.00	0.47	9/16	1.28
JSC 3/16-N3□U	3/16(4.76)	NPT 3/8	0.47	2.11	1.83	1.85	1.57	0.49	0.87	0.67	1.14	0.59	3/4	2.29
JSC 1/4-U10□(K)U	1/4(6.35)	10-32UNF	0.14	1.16	1.06	1.02	0.93	0.49	0.39	0.67	0.94	0.30	5/16	0.33
JSC 1/4-N1□(K)U	1/4(6.35)	NPT 1/8	0.31	1.59	1.34	1.44	1.18	0.49	0.57	0.67	0.93	0.41	7/16	0.69
JSC 1/4-N2□(K)U	1/4(6.35)	NPT 1/4	0.43	1.87	1.61	1.63	1.38	0.49	0.73	0.67	1.00	0.47	9/16	1.27
JSC 1/4-N3□U	1/4(6.35)	NPT 3/8	0.47	2.11	1.83	1.85	1.57	0.49	0.87	0.67	1.14	0.59	3/4	2.26
JSC 5/16-N1□U	5/16(7.94)	NPT 1/8	0.31	1.59	1.34	1.44	1.18	0.57	0.57	0.73	1.06	0.45	7/16	0.74
JSC 5/16-N2□U	5/16(7.94)	NPT 1/4	0.43	1.87	1.61	1.63	1.38	0.57	0.73	0.73	1.12	0.51	9/16	1.32
JSC 5/16-N3□U	5/16(7.94)	NPT 3/8	0.47	2.11	1.83	1.85	1.57	0.57	0.87	0.73	1.14	0.59	3/4	2.28
JSC 5/16-N4□U	5/16(7.94)	NPT 1/2	0.59	2.32	2.03	2.01	1.71	0.57	1.10	0.73	1.22	0.71	1	3.61
JSC 3/8-N2□U	3/8(9.53)	NPT 1/2	0.43	1.87	1.61	1.63	1.38	0.71	0.71	0.81	1.22	0.57	9/16	1.43
JSC 3/8-N3□U	3/8(9.53)	NPT 3/8	0.47	2.11	1.83	1.85	1.57	0.71	0.87	0.81	1.24	0.65	3/4	2.39
JSC 3/8-N4□U	3/8(9.53)	NPT 1/2	0.59	2.32	2.03	2.01	1.17	0.71	1.10	0.81	1.34	0.71	1	3.71
JSC 1/2-N3□U	1/2(12.7)	NPT 3/8	0.47	2.11	1.83	1.85	1.57	0.85	0.87	0.93	1.46	0.71	3/4	2.50
JSC 1/2-N4□U	1/2(12.7)	NPT 1/2	0.59	2.32	2.03	2.01	1.71	0.85	1.10	0.93	1.44	0.77	1	3.81

How to identify speed controller types

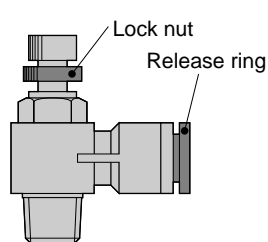

	Release ring Shape · Color	Plastic body Color	Lock nut color	
			Atype	Btype
Standard type	Circle · Black	Black	Silver	Black
Mini type	Oval · Black	Black	Silver	Black
Large flow type	Circle · Black	Black	Blue	—
SUS303 equiv. anti_corrosive type	Circle · Dark blue	Black	Silver	Black
Clean-room Ready type	Circle · Light blue	Light blue	Silver	Black

⚠ Detailed Safety Instructions

Before using the PISCO device, be sure to read the "Safety Instructions", "Common Safety Instructions for Products Listed in This Manual" on page 7 and "Common Safety Instructions for Controllers" on pages 43.

⚠ Warning

- Adjust the speed of the actuator by opening the needle gradually from the fully closed position. With the needle open, there are chances of the actuator flying out. Turn the needle clockwise to close or counterclockwise to open.
- Do not subject the product with a rotatable resin to forcible swinging or rotation. Otherwise the body may suffer damage or develop leakage.

⚠ Caution

- The Speed Controller is designed to tolerate some air flow at fully. Therefore do not use it for applications that permits no air flow.



JSC
MINI TYPE

Elbow Mini

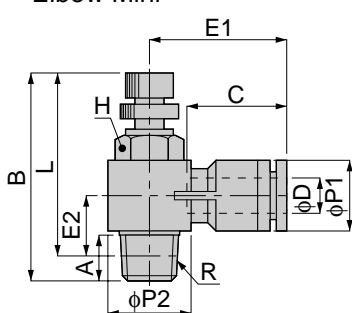

Metric thread type



Model	Tube dia. φD	R	A	B		L		φP1	φP2	C	E1	E2	H	Mass (g)	unit:mm		
				max	min	max	min										
				JSC 3-M3M□(K)	3	M3×0.8	2.5									29.5	26.5
JSC 3-M5M□(K)	3	M5×0.8	3	30.5	27	27.5	25	8	10	11	15.5	6	8	7			
JSC 4-M3M□(K)	4	M3×0.8	2.5	29.5	26.5	27	24.5	8	10	11	15.5	6	8	6.5	1		
JSC 4-M5M□(K)		M5×0.8	3	30.5	27	27.5	25							7			
JSC 4-01M□(K)	4	R1/8	8	40	35	36	31	8	14.5	11	18	10.5	10	16.5	1		
JSC 6-M5M□(K)	6	M5×0.8	3	30.5	27	27.5	25	10.5	14.5	12	17.5	7	8	7.5			
JSC 6-01M□(K)		R1/8	8	40.5	35	36	31							18.5	10.5	10	17.5
JSC 6-02M□(K)		R1/4	11	47.5	41.5	41.5	35.5							18.5	12	14	34
JSC 1/8-M3M□(K)	1/8	M3×0.8	2.5	29.5	26.5	27	24.5	8	10	11	15.5	6	8	6.5	1		
JSC 1/8-M5M□(K)		M5×0.8	3	30.5	27	27.5	25							7			

unit:inch

Model	Tube dia.φD inch(mm)	R	A	B		L		φP1	φP2	C	E1	E2	H	Weight (oz)
				MAX	MIN	MAX	MIN							
JSC 1/8-U10M□(K)U	1/8(3.18)	10-32UNF	0.14	1.18	1.06	1.06	0.94	0.31	0.31	0.43	0.61	0.24	5/16	0.25
JSC 5/32-U10M□(K)U	5/32(3.97)	10-33UNF	0.14	1.18	1.06	1.06	0.94	0.31	0.31	0.43	0.61	0.24	5/16	0.25
JSC 5/32-N1M□U	5/32(3.97)	NPT 1/8	0.31	1.59	1.34	1.44	1.18	0.31	0.57	0.43	0.71	0.41	7/16	0.61