

VC
Pad Direct-Mounting
Air Supply Port Elbow

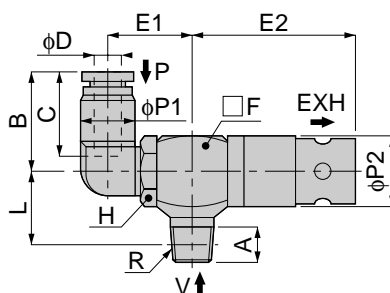

unit:mm

Model	Tube dia. φD	R	A	B	L	φP1	φP2	C	E1	E2	H	□F	*1 (mm)	*2 (-KPa)	*3 (Nℓ/min)	*4 (Nℓ/min)	Mass (g)			
VCH 07-016L	6	R1/8	8	23	16	12.5	16	17	19	38	14	16	0.7	93(73)	13(13)	23(17)	31.5			
VCH 07-018L	8			24		14.5		18.5	20								34			
VCH 10-016L	6			23		12.5		17	19								31.5			
VCH 10-018L	8			24		14.5		18.5	20								34			
VCH 12-016L	6			23		12.5		17	19								31.5			
VCH 12-018L	8			24		14.5		18.5	20								34			
VCH 15-028L	8	R1/4	11	26	21	14.5	24	18.5	23	75	19	22	1.5	63(63)	100(70)	85.5				
VCH 15-038L	8	R3/8	12	20.5	14.5	18.5		23	86.5											
VCH 15-0210L	10	R1/4	11	30	21	17.5		21	25.5							90.5				
VCH 15-0310L	10	R3/8	12	20.5	14.5	18.5		23	91.5											
VCH 20-028L	8	R1/4	11	26	21	14.5		18.5	23							90				
VCH 20-038L	8	R3/8	12	20.5	14.5	18.5		23	91											
VCH 20-0210L	10	R1/4	11	30	21	17.5	21	25.5	95											
VCH 20-0310L	10	R3/8	12	20.5	14.5	18.5	23	96												
VCL 07-016L	6	R1/8	8	23	16	12.5	16	17	19	38	14	16	0.7	67	26	23	31.5			
VCL 07-018L	8			24		14.5		18.5	20								34			
VCL 10-016L	6			23		12.5		17	19								31.5			
VCL 10-018L	8			24		14.5		18.5	20								34			
VCL 15-028L	8			R1/4		11		26	21								14.5	18.5	23	84
VCL 15-038L	8			R3/8		12		20.5	14.5								18.5	23	85	
VCL 15-0210L	10	R1/4	11	30	21	17.5	21	25.5	89											
VCL 15-0310L	10	R3/8	12	20.5	14.5	18.5	23	90												
VCL 20-028L	8	R1/4	11	26	21	14.5	18.5	23	85.5											
VCL 20-038L	8	R3/8	12	20.5	14.5	18.5	23	86.5												
VCL 20-0210L	10	R1/4	11	30	21	17.5	21	25.5	90.5											
VCL 20-0310L	10	R3/8	12	20.5	14.5	18.5	23	91.5												
VCE 07-016L	6	R1/8	8	23	16	12.5	16	17	19	38	14	16	0.7	92	10.5	17	31.5			
VCE 07-018L	8			24		14.5		18.5	20								34			
VCE 10-016L	6			23		12.5		17	19								31.5			
VCE 10-018L	8			24		14.5		18.5	20								34			
VCE 12-016L	6			23		12.5		17	19								31.5			
VCE 12-018L	8			24		14.5		18.5	20								34			
VCE 15-028L	8	R1/4	11	26	21	14.5	24	18.5	23	75	19	22	1.5	92	42	70	86.5			
VCE 15-038L	8	R3/8	12	20.5	14.5	18.5		23	87.5											
VCE 15-0210L	10	R1/4	11	30	21	17.5		21	25.5								91.5			
VCE 15-0310L	10	R3/8	12	20.5	14.5	18.5		23	92.5											
VCE 20-028L	8	R1/4	11	26	21	14.5		18.5	23								91.5			
VCE 20-038L	8	R3/8	12	20.5	14.5	18.5		23	92.5											
VCE 20-0210L	10	R1/4	11	30	21	17.5	21	25.5	96.5											
VCE 20-0310L	10	R3/8	12	20.5	14.5	18.5	23	97.5												

*1 Nozzle dia. *2 Final vacuum *3 Suction flow *4 Air consumption.