

RVCM

Elbow Mounted Gauge

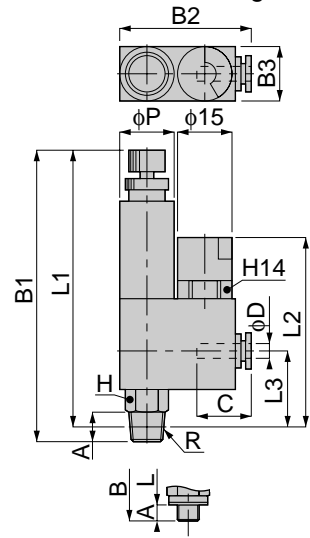

Metric thread type

unit:mm

Model	Tube dia. φD	R	A	B1		B2	B3	L1		L2	L3	φP	C	H	Mass (g)
				max	min			max	min						
RVCM 4-M5	4	M5×0.8	3	57.5	53.5	27.5	15	54.5	50.5	42.5	12.5	11	11	8	27.5
RVCM 4-01		R1/8	8	81.5	77.5	36		77.5	73.5	51.5	18.5	15	15	12	54.5
RVCM 6-M5	6	M5×0.8	3	57.5	53.5	28	15	54.5	50.5	42.5	12.5	11	11.5	8	27.5
RVCM 6-01		R1/8	8	81.5	77.5	36.5		77.5	73.5	51.5	18.5	15	17	12	54.5
RVCM 6-02		R1/4	11	89.5	85.5	39.5		83.5	79.5	57	22.5	19	18	16	83.5
RVCM 8-01	8	R1/8	8	81.5	77.5	36.5	15	77.5	73.5	51.5	18.5	15	18	12	55
RVCM 8-02		R1/4	11	89.5	85.5	39.5	19	83.5	79.5	57	22.5	19	16	83.5	



unit:inch

Model	Tube dia.φD inch(mm)	R	A	B1		B2	B3	L1		L2	L3	φP	C	H	Weight (oz)
				MAX	MIN			MAX	MIN						
RVCM 5/32-U10U	5/32(3.97)	10-32UNF	0.14	2.26	2.11	1.08	0.59	2.13	1.97	1.65	0.47	0.43	0.43	5/16	0.98
RVCM 5/32-N1U	5/32(3.97)	10-32UNF	0.31	3.21	3.05	1.42	0.59	3.05	2.89	2.03	0.73	0.59	0.59	1/2	1.96
RVCM 1/4-N1U	1/4(6.35)	NPT 1/8	0.31	3.21	3.05	1.44	0.59	3.05	2.89	2.03	0.73	0.59	0.67	1/2	2.25
RVCM 1/4-N2U	1/4(6.35)	NPT 1/4	0.43	3.52	3.37	1.56	0.75	3.29	3.13	2.24	0.89	0.75	0.67	11/16	3.32
RVCM 5/16-N1U	5/16(7.94)	NPT 1/8	0.31	3.21	3.05	1.44	0.59	3.05	2.89	2.03	0.73	0.59	0.71	1/2	1.99
RVCM 5/16-N2U	5/16(7.94)	NPT 1/4	0.43	3.52	3.37	1.56	0.75	3.29	3.13	2.24	0.89	0.75	0.71	11/16	3.07

RVUM

Gauge Union

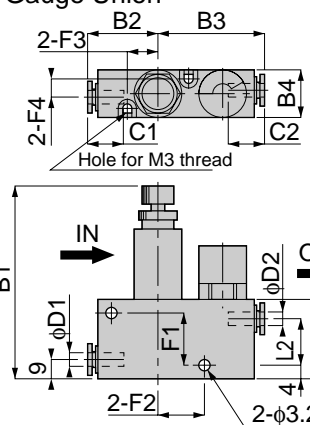

unit:mm

Model	Tube dia. φD1	Tube dia. φD2	B1		B2	B3	B4	L1	L2	C1	C2	F1	F2	F3	F4	Mass (g)
			max	min												
RVUM 4-4	4	4	63	59	22	33	15	25	15	11.5	11.5	17	15	10	4.5	47.5
RVUM 6-4	6	4	63	59	22.5	33	15	25	15	12	11.5	17	15	10	4.5	47.5
RVUM 6-6		6				33.5					12					
RVUM 8-6	8	6	67.5	63.5	28.5	40.5	19	29	17	18.5	17.5	21	19.5	11.5	6.5	73
RVUM 8-8		8									18.5					



Flow characteristics

Straight type

RVC 4-M5
6-M5

RVS 4-M5
6-M5

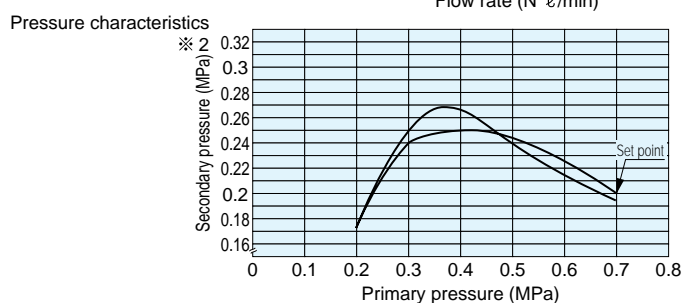
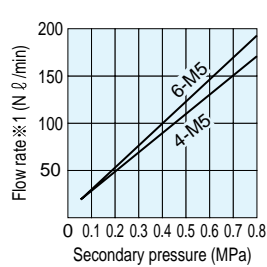
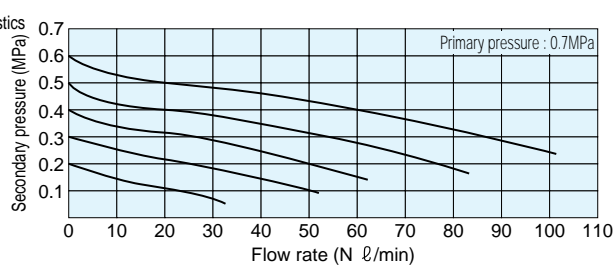

※1. Flow from secondary to primary.
 ※2. Primary pressure varies from 0.7 to 0.2 to 0.7 Mpa.