

Metric thread type

unit:mm

Model	Tube dia. $\phi$ D	R	A	B		L		$\phi$ P1	$\phi$ P2	C	E1	E2	H	Mass (g)
				max	min	max	min							
RVC 4-M5	4	M5x0.8	3	48.5	44.5	45.5	41.5	8	10	11	15.5	7	10	16
RVC 4-01		R1/8	8	60	56	56	52	10	14	15	21.5	10.5	14	35.5
RVC 6-M5	6	M5x0.8	3	48.5	44.5	45.5	41.5	10.5	10	11.5	17.5	7.5	10	16.5
RVC 6-01		R1/8	8	60	56	56	52	12.5	14	17	23.5	10.5	14	36.5
RVC 6-02	R1/4	11	65	61	59	55	17	17	17	25.5	12	17	59	
RVC 8-01	8	R1/8	8	60	56	56	52	14.5	14	18.5	27	11.5	14	38
RVC 8-02		R1/4	11	65	61	59	55	17	17		28.5	13	17	60



unit:inch

Model	Tube dia. $\phi$ D inch(mm)	R	A	B		L		$\phi$ P1	$\phi$ P2	C	E1	E2	H	Weight (oz)
				MAX	MIN	MAX	MIN							
RVC 5/32-U10U	5/32(3.97)	10-32UNF	0.14	1.91	1.75	1.77	1.61	0.31	0.39	0.43	0.61	0.28	7/16	0.62
RVC 5/32-N1U	5/32(3.97)	NPT 1/8	0.31	2.36	2.20	2.20	2.05	0.39	0.55	0.59	0.85	0.41	9/16	1.24
RVC 3/16-U10U	3/16(4.76)	10-32UNF	0.14	1.91	1.75	1.77	1.61	0.41	0.39	0.45	0.98	0.30	7/16	0.66
RVC 3/16-N1U	3/16(4.76)	NPT 1/8	0.31	2.36	2.20	2.20	2.05	0.49	0.55	0.67	0.93	0.41	9/16	1.27
RVC 3/16-N2U	3/16(4.76)	NPT 1/4	0.43	2.56	2.40	2.32	2.17	0.49	0.67	0.67	1.00	0.47	11/16	2.11
RVC 1/4-U10U	1/4(6.35)	10-32UNF	0.14	1.91	1.75	1.77	1.61	0.41	0.39	0.45	0.98	0.30	7/16	0.65
RVC 1/4-N1U	1/4(6.35)	NPT 1/8	0.31	2.36	2.20	2.20	2.05	0.49	0.55	0.67	0.93	0.41	9/16	1.27
RVC 1/4-N2U	1/4(6.35)	NPT 1/4	0.43	2.56	2.40	2.32	2.17	0.49	0.67	0.67	1.00	0.47	11/16	2.10
RVC 5/16-N1U	5/16(7.94)	NPT 1/8	0.31	2.36	2.20	2.20	2.05	0.57	0.55	0.73	1.06	0.45	9/16	1.32
RVC 5/16-N2U	5/16(7.94)	NPT 1/4	0.43	2.56	2.40	2.32	2.17	0.57	0.67	0.73	1.12	0.51	11/16	2.15

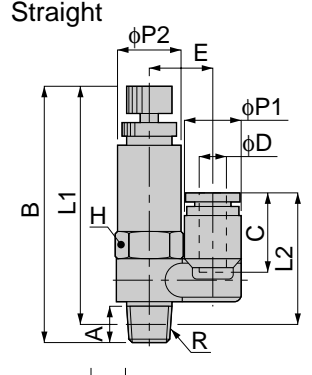

Metric thread type

unit:mm

Model	Tube dia. $\phi$ D	R	A	B		L1		L2	$\phi$ P1	$\phi$ P2	C	E	H	Mass (g)
				max	min	max	min							
RVS 4-M5	4	M5x0.8	3	48.5	44.5	45.5	41.5	24	10	10	15	10.5	10	18
RVS 4-01		R1/8	8	60	56	56	52	28.5				14	13	14
RVS 6-M5	6	M5x0.8	3	48.5	44.5	45.5	41.5	26.5	12.5	14	17	12	10	18.5
RVS 6-01		R1/8	8	60	56	56	52	31				14	14	37.5
RVS 6-02	R1/4	11	65	61	59	55	32	17	17	17	60.5			
RVS 8-01	8	R1/8	8	60	56	56	52	32	14.5	14	18.5	15	14	39
RVS 8-02		R1/4	11	65	61	59	55	33.5				17	18	17



unit:inch

Model	Tube dia. $\phi$ D inch(mm)	R	A	B		L1		L2	$\phi$ P1	$\phi$ P2	C	E	H	Weight (oz)
				MAX	MIN	MAX	MIN							
RVS 5/32-U10U	5/32(3.97)	10-32UNF	0.14	1.91	1.75	1.77	1.61	0.93	0.39	0.39	0.59	0.43	7/16	0.63
RVS 5/32-N1U	5/32(3.97)	NPT 1/8	0.31	2.36	2.20	2.20	2.05	1.12	0.39	0.55	0.59	0.51	9/16	1.27
RVS 3/16-U10U	3/16(4.76)	10-32UNF	0.14	1.91	1.75	1.77	1.61	1.02	0.49	0.39	0.67	0.47	7/16	0.68
RVS 3/16-N1U	3/16(4.76)	NPT 1/8	0.31	2.36	2.20	2.20	2.05	1.22	0.49	0.55	0.67	0.55	9/16	1.32
RVS 3/16-N2U	3/16(4.76)	NPT 1/4	0.43	2.56	2.40	2.32	2.17	1.26	0.49	0.67	0.67	0.67	11/16	2.16
RVS 1/4-U10U	1/4(6.35)	10-32UNF	0.14	1.91	1.75	1.77	1.61	1.02	0.49	0.39	0.67	0.47	7/16	0.66
RVS 1/4-N1U	1/4(6.35)	NPT 1/8	0.31	2.36	2.20	2.20	2.05	1.22	0.49	0.55	0.67	0.55	9/16	1.31
RVS 1/4-N2U	1/4(6.35)	NPT 1/4	0.43	2.56	2.40	2.32	2.17	1.26	0.49	0.67	0.67	0.67	11/16	2.15
RVS 5/16-N1U	5/16(7.94)	NPT 1/8	0.31	2.36	2.20	2.20	2.05	1.26	0.57	0.55	0.73	0.59	9/16	1.36
RVS 5/16-N2U	5/16(7.94)	NPT 1/4	0.43	2.56	2.40	2.32	2.17	1.32	0.57	0.67	0.73	0.63	11/16	2.20

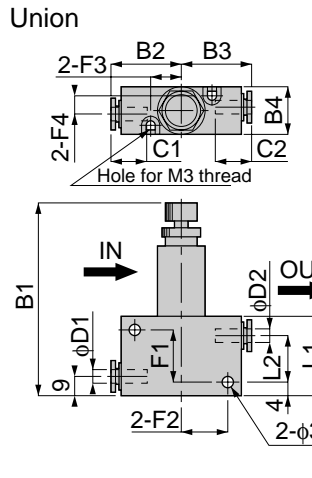

unit:mm

Model	Tube dia. $\phi$ D1	Tube dia. $\phi$ D2	B1		B2	B3	B4	L1	L2	C1	C2	F1	F2	F3	F4	Mass (g)
			max	min												
RVU 4-4	4	4	63	59	22	22	15	25	15	11.5	11.5	17	15	10	4.5	35.5
RVU 6-4	6	4	63	59	22.5	22.5	15	25	15	12	11.5	17	15	10	4.5	35.5
RVU 6-6		6														
RVU 8-6	8	6	67.5	63.5	28.5	28.5	19	29	17	18.5	17.5	21	19.5	11.5	6.5	60
RVU 8-8		8														

