

Tube Fitting Series Die Temperature Control Fitting

AKC

Straight

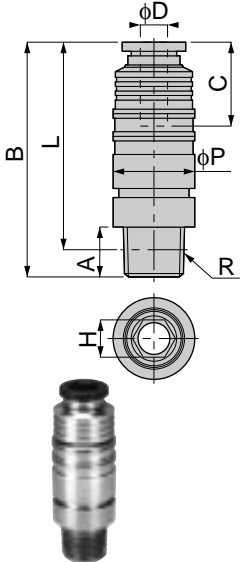

unit:mm

Model	Tube (I.D.×O.D.) φD	R	A	B	L	φP	C	H	Mass (g)	Orifice (φmm)	Eff.a.(cv) (mm ²)
AKC 08-601	6×4	R1/8	8	44	40	15	17	5	33	4.8	13.5(0.7)
AKC 08-602		R1/4	11	45.5	39.5			6	36		13.6(0.71)
AKC 08-801	8×6	R1/8	8	44.5	40.5	15	18.5	5	31.5	5.3	19.3(1.4)
AKC 08-802		R1/4	11	46	40			6	34.5	6	23.9(1.52)
AKC 10-801	8×6	R1/8	8	49.5	45.5	18	18.5	5	52	5.3	17.5(1.06)
AKC 10-802		R1/4	11	51.5				52.5	6	18.7(1.11)	
AKC 10-803		R3/8	12		45			59			6
AKC 10-804		R1/2	15	54.5	46.5			22			
AKC 10-1001	10×7.5	R1/8	8	52	48	18	21	5	52.5	5.3	18.5(1.42)
AKC 10-1002		R1/4	11	54				53	7.5	27.9(1.71)	
AKC 10-1003		R3/8	12		47.5			59.5		7.5	28.2(1.76)
AKC 10-1004		R1/2	15	57	49			22			
AKC 10-1201	12×9	R1/8	8	61	57	18	23.5	5	74.5	5.3	18.5(1.5)
AKC 10-1202		R1/4	11	63				74	7.5	34.6	
AKC 10-1203		R3/8	12		56.5			80.5		7.5	(1.95)
AKC 10-1204		R1/2	15	66	58			22			

unit:inch

MODEL	Tube dia. φ D	NPT	A	B	L	φ P	C	H	Weight (oz)	Orifice φ inch
AKC 08-5/16N1U	5/16	1/8	0.31	1.75	1.59	0.59	0.73	3/16	1.12	0.21
AKC 08-5/16N2U	5/16	1/4	0.43	1.81	1.57	0.59	0.73	7/32	1.22	0.24
AKC 10-5/16N1U	5/16	1/8	0.31	1.95	1.79	0.71	0.73	3/16	1.79	0.21
AKC 10-5/16N2U	5/16	1/4	0.43	2.03	1.79	0.71	0.73	5/16	1.81	0.24
AKC 10-5/16N3U	5/16	3/8	0.47	2.03	1.77	0.71	0.73	5/16	2.04	0.24
AKC 10-3/8N1U	3/8	1/8	0.34	2.05	1.89	0.71	0.83	3/16	1.87	0.21
AKC 10-3/8N2U	3/8	1/4	0.43	2.13	1.89	0.71	0.83	5/16	1.89	0.30
AKC 10-3/8N3U	3/8	3/8	0.47	2.13	1.87	0.71	0.83	5/16	2.13	0.30

AKL

Elbow

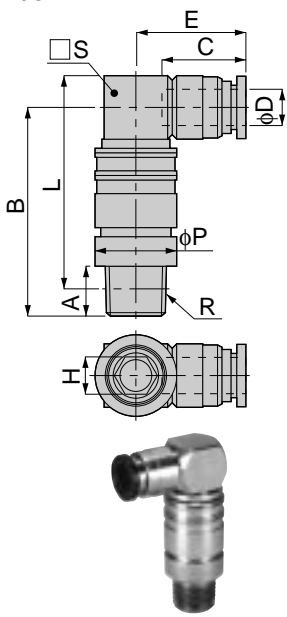

unit:mm

Model	Tube (I.D.×O.D.) φD	R	A	B	L	φP	C	E	H	S	Mass (g)	Orifice (φmm)	Eff.a.(cv) (mm ²)
AKL 08-601	6×4	R1/8	8	37	39	15	17	22	5	12	47	4	9.2(0.49)
AKL 08-602		R1/4	11	38.5	38.5						50		9.5(0.5)
AKL 08-801	8×6	R1/8	8	38	41	15	18.5	24	5	14	52.5	5.3	18.9(1.06)
AKL 08-802		R1/4	11	39.5	40.5						55.5	6	18.4(1.1)
AKL 10-801	8×6	R1/8	8	43.5	46.5	18	18.5	24	5	14	57.5	5.3	18.4(1.37)
AKL 10-802		R1/4	11	45.5							58	6	24.8(1.55)
AKL 10-803		R3/8	12		46						65		6
AKL 10-804		R1/2	15	48.5	47.5						22		
AKL 10-1001	10×7.5	R1/8	8	45	49.5	18	21	28	5	17	87.5	5.3	18.5(1.63)
AKL 10-1002		R1/4	11	47							88	7.5	33.5(2.35)
AKL 10-1003		R3/8	12		49						94.5		7.5
AKL 10-1004		R1/2	15	50	50.5						22		
AKL 10-1201	12×9	R1/8	8	50.5	56.5	18	23.5	31	5	20	127	5.3	18.8(1.69)
AKL 10-1202		R1/4	11	52.5							126.5	7.5	34.8
AKL 10-1203		R3/8	12		56						133		7.5
AKL 10-1204		R1/2	15	55.5	57.5						22		

unit:inch

MODEL	Tube dia. φ D	NPT	A	B	L	φ P	C	E	H	□S	Weight (oz)	Orifice φ inch
AKL 08-5/16N1U	5/16	1/8	0.31	1.5	1.34	0.59	0.73	0.94	3/16	□.55	1.84	0.21
AKL 08-5/16N2U	5/16	1/4	0.43	1.56	1.32	0.59	0.73	0.94	7/32	□.55	1.95	0.24
AKL 10-5/16N1U	5/16	1/8	0.31	1.71	1.56	0.71	0.73	0.94	3/16	□.55	2.42	0.21
AKL 10-5/16N2U	5/16	1/4	0.43	1.79	1.56	0.71	0.73	0.94	5/16	□.55	2.44	0.24
AKL 10-5/16N3U	5/16	3/8	0.47	1.79	1.54	0.71	0.73	0.94	5/16	□.55	2.68	0.24
AKL 10-3/8N1U	3/8	1/8	0.31	1.77	1.61	0.71	0.83	1.1	3/16	□.67	3.09	0.21
AKL 10-3/8N2U	3/8	1/4	0.43	1.85	1.61	0.71	0.83	1.1	5/16	□.67	3.1	0.30
AKL 10-3/8N3U	3/8	3/8	0.47	1.85	1.59	0.71	0.83	1.1	5/16	□.67	3.34	0.30

AKC PARTS

Straight Joint Part only

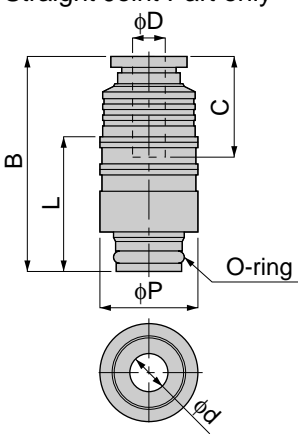

unit:mm

Model	Tube (I.D.×O.D.) φD	B	L	φP	C	φd	Mass (g)	Orifice (φmm)
AKC 08-6P	6×4	34	19	14	17	4.8	23	4.8
AKC 08-8P	8×6	34.5	19	14	18.5	6.1	21.5	6.1
AKC 10-8P	8×6	39	24	18	18.5	8.1	37	7
AKC 10-10P	10×7.5	41.5	24	18	21	8.1	37.5	8.1
AKC 10-12P	12×9	50.5	24	18	23.5	8.1	55.5	8.1

