

Quick-fitting Joint for Rotating Multiple Circuit Multi-Circuit Rotary Block

Features

- The Multi-Circuit Rotary Block are best suited to piping for index tables or other rotary equipment.
- A single block can serve 4 circuits, 6 circuits or 8 circuits.

Specification

Fluid admitted	Air
Service pressure range	0~150 psi (0~0.9MPa)
Working vacuum	-29.5 in.Hg (-100 kPa)
Service temperature range	32~140°F (0~60°C)

Model Designation(Example)

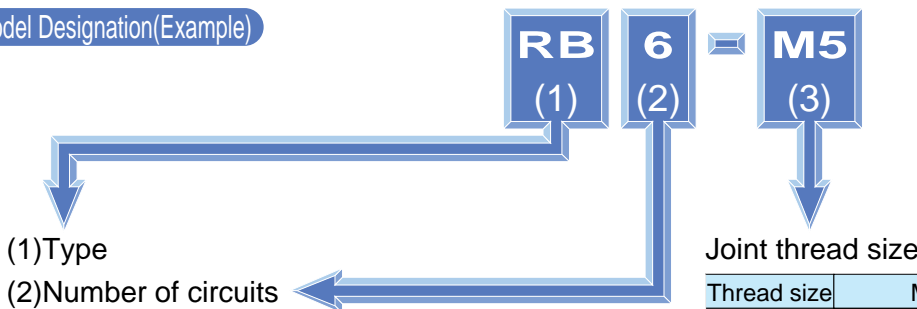

(1)Type

(2)Number of circuits

Code	4	6	8
Size	4 circuit	6 circuit	8 circuit

Joint thread size

Thread size	Metric thread(mm)	Taper pipe thread	
Code	M5	M6	O1
Size	M5×0.8	M6×1	R1/8

⚠ Detailed Safety Instruction

Before using the PISCO device, be sure to read the "Safety Instructions", "Common Safety Instructions for Products Listed in this Manual" on page 23~24 and "Common Safety Instructions for Quick-Fitting Joint" on page 29~31.

⚠ Warning

1. Some working conditions may not permit the use of Multi-Circuit Rotary Block. Contact PISCO for information.

RB

Multi-circuit Rotary Block



RB4 - □ □

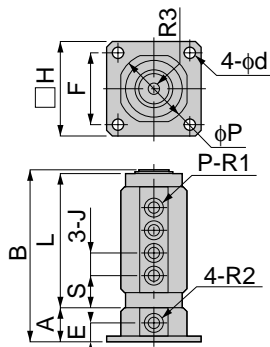

RB6 - □ □

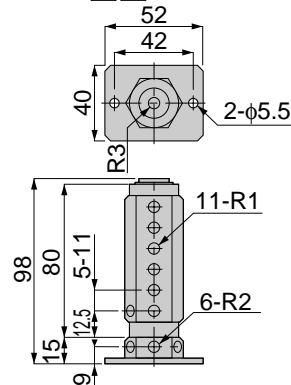

RB8 - □ □

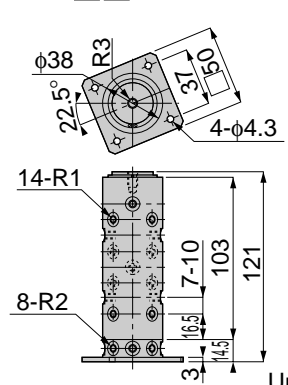

Unit:mm

Type	R1	R2	R3	A	B	L	φP	J	S	E	□H	φd	F	P	Mass (g)
RB 4-M5	M5×0.8	M5×0.8	M5×0.8depth6	13	71	55	23	10	12.5	8	32	4.5	24	8	190
RB 4-O1	Rc1/8	Rc1/8	M6×1depth10	18.5	91	70	38	12.5	16	10.5	50	5.5	38	7	630
RB 6-M5	M5×0.8	M5×0.8	M5×0.8depth8	-	-	-	-	-	-	-	-	-	-	-	460
RB 6-M6	M6×1	M6×1	M6×1depth8	-	-	-	-	-	-	-	-	-	-	-	430
RB 8-M5	M5×0.8	M5×0.8	M6×1	-	-	-	-	-	-	-	-	-	-	-	950
RB 8-M6	M6×1	M6×1	depth10	-	-	-	-	-	-	-	-	-	-	-	940

*Mass doesn't include connected tube fitting joints.

*Outer dimension of RBG-MS is a cylinder of φ29mm. (Attachment plate is the same as that of RB6-M6.)