

# Tube Fitting Series Stop Fitting

unit:mm

## PSC

Straight

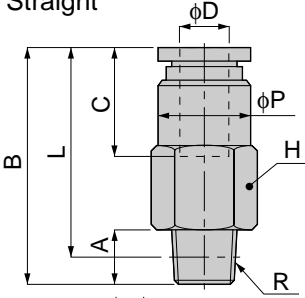

Metric thread type



Model	Tube dia. $\phi D$	R	A	B	L	$\phi P$	C	H	Mass (g)	Eff. a. (mm <sup>2</sup> )
PSC 4-M5	4	M5×0.8	3	28.5	25.5	8	12.5	8	7	1.6
PSC 4-01		R1/8	8	24	20	9		10	9.5	2
PSC 6-M5	6	M5×0.8	3	32	29	10	13.5	10	11	2.3
PSC 6-01		R1/8	8	27	23				9.5	
PSC 6-02		R1/4	11	21	12	21				
PSC 8-01	8	R1/8	8	36	32	14	22.5	14	22.5	9.1
PSC 8-02		R1/4	11		30				18.5	14.2
PSC 8-03		R3/8	12	29.5	15	17	39	15.8		
PSC 10-02	10	R1/4	11	38.5	32.5	17	25	17	31	17.8
PSC 10-03		R3/8	12	40	33.5				35	
PSC 10-04		R1/2	15	40	32	18		21	63	24.9
PSC 12-03	12	R3/8	12	46	39.5	21	29.5	21	63.5	28.8
PSC 12-04		R1/2	15		38				23.5	

unit:mm

## PSL

Elbow

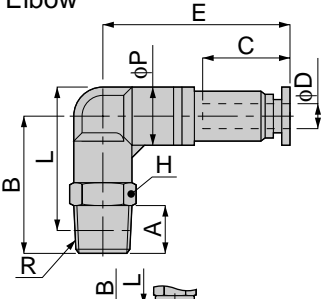

Metric thread type



Model	Tube dia. $\phi D$	R	A	B	L	$\phi P$	C	E	H	Mass (g)	Eff. a. (mm <sup>2</sup> )
PSL 4-M5	4	M5×0.8	3	20.5	22.5	10	12.5	30	10	14	1.5
PSL 4-01		R1/8	8	23.5	24.5					17	1.8
PSL 6-M5	6	M5×0.8	3	22	25	12.5	13.5	30.5	12	19.5	2.3
PSL 6-01		R1/8	8	25	27					22	6.8
PSL 6-02		R1/4	11	28	28	14			29.5	8.1	
PSL 8-01	8	R1/8	8	28	31	14.5	18.5	43	14	34	13.7
PSL 8-02		R1/4	11	31	32					40	13.2
PSL 8-03		R3/8	12	33	33.5	17			53	14.5	
PSL 10-02	10	R1/4	11	36	38.5	17.5	21	49.5	17	58.5	21.4
PSL 10-03		R3/8	12	37	39					67	21.9
PSL 10-04		R1/2	15	40	40.5	21			89	21.3	
PSL 12-03	12	R3/8	12	39	43	21	23.5	57.5	21	92.5	30.2
PSL 12-04		R1/2	15	42	44.5					107	29.8

unit:mm

## PSU

Union Straight

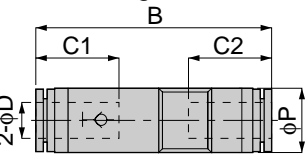

Model	Tube dia. $\phi D$	B	$\phi P$	C1	C2	Mass (g)	Eff. a. (mm <sup>2</sup> )
PSU 4M	4	36	8.5	10	11	3.5	2
PSU 6M	6	39.5	11	11	11.5	6	7.1
PSU 8	8	54.5	14.5	18	18	16	15.4
PSU 10	10	60.5	17.5	20	20	26	22.4
PSU 12	12	70.5	21	23.5	23.5	40.5	30

※Models marked with Mat the end is mini-type.

unit:mm

## PSM

Bulkhead Union

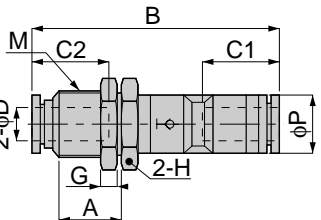

Model	Tube dia. $\phi D$	M	A	B	L	$\phi P$	C1	C2	H	G	Mass (g)	Eff. a. (mm <sup>2</sup> )
PSM 4	4	M10×1	9	45.5	27	10	15	15	12	3	13	1.7
PSM 6	6	M12×1	9	50	30.5	12.5	17	16.5	14	4	19.5	7.2
PSM 8	8	M16×1	14	58.5	33.5	14.5	18	18	19	4	37.5	14.7
PSM 10	10	M20×1	16	67	39	17.5	20	20	24	5	67.5	22.8
PSM 12	12	M22×1	20	76	43	21	23.5	23.5	27	6	97.5	30.7

※In PSM 4 and 6, thread side is mini-type joint and plastic side is standard-type joint.