

Tube Fitting Series Brass

unit:mm

KC
BRASS

Straight

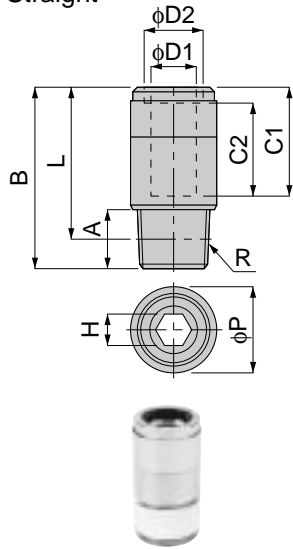

Model	Tube dia. φD1	Tube dia. φD2	R	A	B	L	φP	C1	C2	H	Mass (g)	Orifice (φmm)	Eff. a. (mm²)
KC 6-01	6	8	R1/8	8	25	21	12	19.5	16.5	4	10.5	4	11
KC 6-02			R1/4	11		19	14				15		
KC 6-03			R3/8	12		26	19.5				17		
KC 8-01	8	10	R1/8	8	30	26	14	20	17	5	16.5	6	17
KC 8-02			R1/4	11	28.5	22.5	6			17.5	20		
KC 8-03			R3/8	12	26	19.5	17			28.5	20		
KC 10-01	10	12	R1/8	8	33.5	29.5	17	23.5	19.5	5	25	6	17
KC 10-02			R1/4	11	32.5	26.5				6	26	8	20
KC 10-03			R3/8	12	32	25.5				32	49		
KC 10-04			R1/2	15	33	25	21						
KC 12-02	12	14	R1/4	11	39	33	20	26.5	22.5	8	45.5	9	40
KC 12-03			R3/8	12	35	28.5	40						
KC 12-04			R1/2	15	37	29	55.5						

unit:mm

KL
BRASS

Elbow

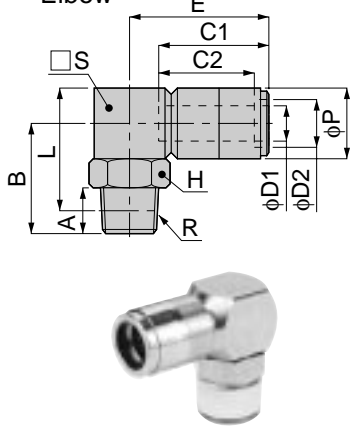

Model	Tube dia. φD1	Tube dia. φD2	R	A	B	L	φP	C1	C2	E	H	S	Mass (g)	Orifice (φmm)	Eff. a. (mm²)
KL 6-01	6	8	R1/8	8	19	21	12	19.5	16.5	24	12	12	28	4	9
KL 6-02			R1/4	11	22	23					14	12	36		
KL 6-03			R3/8	12	24	23.5					17	49.5			
KL 8-01	8	10	R1/8	8	20	23	14	20	17	26	14	14	37	6	20
KL 8-02			R1/4	11	23	25					14	42.5			
KL 8-03			R3/8	12	25	25.5					17	55.5			
KL 10-01	10	12	R1/8	8	22.5	27	17	23.5	19.5	30.5	17	17	59	6	25
KL 10-02			R1/4	11	25.5	29							64		
KL 10-03			R3/8	12	26.5	28.5							71		
KL 10-04			R1/2	15	29.5	30				21	94.5				
KL 12-02	12	14	R1/4	11	27	32	20	26.5	22.5	34	21	20	101	9	43
KL 12-03			R3/8	12	28	31.5							106		
KL 12-04			R1/2	15	31	33							123.5		

unit:mm

KB
BRASS

Tee

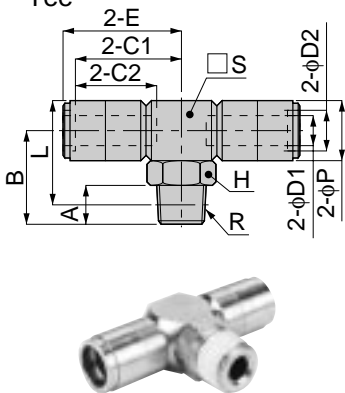

Model	Tube dia. φD1	Tube dia. φD2	R	A	B	L	φP	C1	C2	E	H	S	Mass (g)	Orifice (φmm)	Eff. a. (mm²)
KB 6-01	6	8	R1/8	8	19	21	12	19.5	16.5	24	12	12	35	4	9
KB 6-02			R1/4	11	22	23					14	12	43		
KB 6-03			R3/8	12	24	23.5					17	56.5			
KB 8-01	8	10	R1/8	8	20	23	14	20	17	26	14	14	46	6	20
KB 8-02			R1/4	11	23	25					14	51.5			
KB 8-03			R3/8	12	25	25.5					17	64.5			
KB 10-02	10	12	R1/4	11	25.5	29	17	23.5	19.5	30.5	17	17	77	8	35
KB 10-03			R3/8	12	26.5	28.5							85		
KB 10-04			R1/2	15	29.5	30							109		
KB 12-02	12	14	R1/4	11	27	32	20	26.5	22.5	34	21	20	122	9	43
KB 12-03			R3/8	12	28	31.5							128.5		
KB 12-04			R1/2	15	31	33							146		