

APC Straight

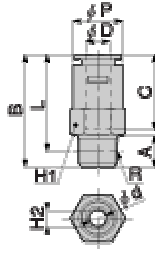

Unit : mm

Model	Tube D.	R	A	B	L	C	Hex. H1	Hex. H2	φP	φd	Weight (g)	Orifice dia. (φmm)	Eff. sect. Area (mm <sup>2</sup> )	CAD file No.
APC4-01□	4	R1/8	8	26.4	22.4	17.4	10	2.5	10.5	2.5	2.3	2.5	4.5	TFAP-001
APC6-01□	6	R1/8	8	28.6	24.7	19.1	12	4	12.5	4	2.9	4	11	
APC6-02□		R1/4	11	31.6	25.6		14				4.4			
APC8-01□	8	R1/8	8	30.6	26.7	20.6	14	4	14.5	4	3.8	4	11	
APC8-02□		R1/4	11	33.6	27.6						6			
APC10-02□	10	R1/4	11	35.7	29.7	23.2	17	6	17.8	6	6.4	6	23	
APC10-03□		R3/8	12	36.7	30.3						8			
APC12-02□	12	R1/4	11	39.4	33.4	26.4	19	6	22	6	9.6	6	23	
APC12-03□		R3/8	12	40.4	34						8			
APC12-04□		R1/2	12	36.4	28.2		22	10		10	13	10	55	

\*1. L dimension is a reference dimension after tightening screw.

\*2. Please enter C in the □ of model code only when Clean room specification is required.