

Tube Fitting Series SUS303 Type

New
SPRX
SUS303

Branch Double Y

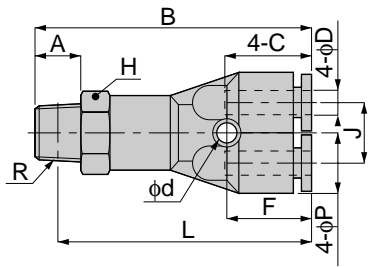

Model	Tube dia. ϕD	R	A	B	L	ϕP	C	J	H	ϕd	F	Mass (g)	Orifice (ϕmm)	Eff. a. (mm^2)
SPRX 4-01	4	R1/8	8	46	42	10.5	15	10	12	3.2	14	21.5	2.3	1.5
SPRX 4-02		R1/4	11	49	43				14					1.4
SPRX 6-01	6	R1/8	8	50.5	46.5	13	17	13	14	3.5	16	29	3.9	9

unit:mm

New
SPKG
SUS303

Different Diam. Triple

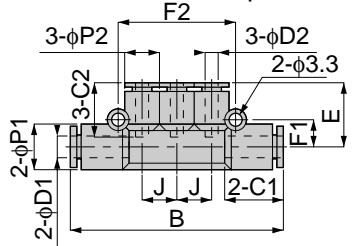

Model	Tube dia. $\phi D1$	Tube dia. $\phi D2$	B	$\phi P1$	$\phi P2$	C1	C2	J	E	F1	F2	Mass (g)	Orifice (ϕmm)	Eff. a. (mm^2)
SPKG 6-4	6	4	60	13	10	17	15	10	18.5	8	34	16	3	5
SPKG 8-4	8	4	62.5	15	10	18	15	10	19	9	34	19	3	6
SPKG 8-6		6	69.5		13		17	12	21		40			
SPKG 10-6	10	6	80	18	15	20	17	14	24	10.5	46	31	4.6	11.2
SPKG 10-8		8					18		18					

unit:mm

New
SPKD
SUS303

Branch Triple

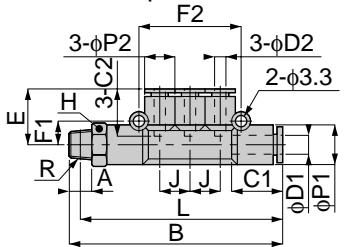

Model	Tube dia. $\phi D1$	Tube dia. $\phi D2$	R	A	B	L	$\phi P1$	$\phi P2$	C1	C2	J	E	H	F1	F2
SPKD 6-4-01	6	4	R1/8	8	68.5	64.5	13	10	17	15	10	18.5	12	8	34
SPKD 8-4-02	8	4	R1/4	11	74	68	15	10	18.5	15	10	19.5	14	9	34
SPKD 8-6-02		6			81	75				13	17	12			20
SPKD 10-8-03	10	8	R3/8	12	93.5	87	18	15	20.5	18.5	14	24	17	10.5	46

unit:mm

Model	Mass (g)	Orifice (ϕmm)	Eff. a. (mm^2)
SPKD 6-4-01	23	3	5
SPKD 8-4-02	33.5	3	5.2
SPKD 8-6-02	36.5	4.6	9.6
SPKD 10-8-03	59.5	7	19.1

New
SPVU
SUS303

Tripod Union

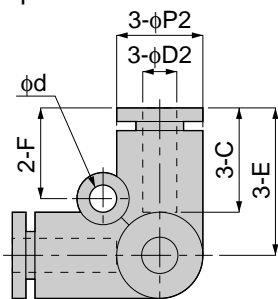

Model	Tube dia. ϕD	ϕP	C	E	ϕd	F	Mass (g)	Orifice (ϕmm)	Eff. a. (mm^2)
SPVU 4	4	10	15	17	3.2	10.5	7.5	3	3.7
SPVU 6	6	12.5	17	20.5	4.2	12.5	10.5	4.6	8.3
SPVU 8	8	14.5	18	22.5	4.2	12.5	15	6	16
SPVU 10	10	18	20	26.5	4.2	14.5	25.5	8	30.2
SPVU 12	12	21.5	23.5	29.5	4.2	15.5	36	10	40.2

unit:mm