

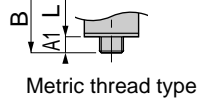

PF

Extension Joint Bush

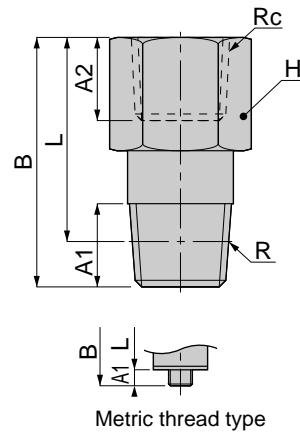

Model	R	Rc	A1	A2	B	L	H	Mass (g)	Orifice (φmm)	Eff. a. (mm ²)	unit:mm	
PF M5-M5	M5×0.8	M5×0.8	3	5	19.5	16.5	8	5	1.8	2.2	1	
PF M5-M5L		M5×0.8			23	20		6.5				
PF M5-01		Rc1/8		8	14.5	12	14	11				
PF 01-M5	R1/8	M5×0.8	8	6	12	8	10	6	4.2	12	3	
PF 01-01		Rc1/8		8	28.5	24.5	14	17				
PF 01-02		Rc1/4		11	21	15	17	19				
PF 01-03		Rc3/8		12	22	15.5	21	28				
PF 02-M5	R1/4	M5×0.8	11	6	16	10	14	16	4.2	11.9	3	
PF 02-01		Rc1/8		8	19	13		16.5				4.6
PF 02-02		Rc1/4		11	33	27	17	31.5				8
PF 02-03		Rc3/8		12	25	18.5	21					
PF 02-04		Rc1/2		15	30	22	24					
PF 03-01	R3/8	M5×0.8	12	8	17.5	11	17	25	6	25.3	3	
PF 03-02		Rc1/4		11	22.5	16.5		26.5				8
PF 03-03		Rc3/8		12	37	30.5	21	54				10
PF 03-04		Rc1/2		15	31	23	24	47.5				
PF 04-04	R1/2	Rc1/2	15	15	43	35	24	85	11	80.9	3	



2

unit:inch

MODEL	NPT	NPT(f)	A1	A2	B	L	H	Weight (g)	Orifice φMM	Eff.a. mm ²	Cv
PF U10-U10U	10-32UNF	10-32UNF	0.14	0.14	0.77	0.63	5/16	5.2	1.8	2.2	0.12
PF U10-N1U	10-32UNF	1/8	0.14	0.31	0.57	0.43	9/16	10.4	1.8	2.4	0.13
PF N1-U10U	1/8	10-32UNF	0.31	0.14	0.47	0.31	7/16	6.5	4.2	12.0	0.65
PF N1-N1U	1/8	1/8	0.31	0.31	1.12	0.96	9/16	17.0	6.0	22.0	1.19
PF N1-N2U	1/8	1/4	0.31	0.43	0.83	0.59	11/16	19.3	6.0	24.1	1.31
PF N1-N3U	1/8	3/8	0.31	0.47	0.87	0.71	7/8	31.2	6.0	23.9	1.30
PF N2-U10U	1/4	10-32UNF	0.43	0.14	0.63	0.49	9/16	16.4	4.2	11.9	0.64
PF N2-N1U	1/4	1/8	0.43	0.31	0.75	0.51	9/16	16.5	4.6	24.1	1.31
PF N2-N2U	1/4	1/4	0.43	0.47	1.30	1.06	11/16	32.6	8.0	44.7	2.42
PF N2-N3U	1/4	3/8	0.43	0.47	0.98	0.75	7/8	34.8	8.0	46.7	2.53
PF N2-N4U	1/4	1/2	0.43	0.59	1.18	0.94	1.00	47.1	8.0	46.5	2.52
PF N3-N1U	3/8	1/8	0.47	0.31	0.69	0.43	11/16	24.8	6.0	25.3	1.37
PF N3-N2U	3/8	1/4	0.47	0.43	0.89	0.63	11/16	26.7	8.0	43.0	2.33
PF N3-N3U	3/8	3/8	0.47	0.47	1.46	1.20	7/8	56.4	10.0	68.1	3.69
PF N3-N4U	3/8	1/2	0.47	0.59	1.22	0.96	1.00	51.7	10.0	67.5	3.66
PF N4-N4U	1/2	1/2	0.59	0.59	1.69	1.38	1.00	93.2	11.0	80.9	4.38



PFF

Different Diam. Socket

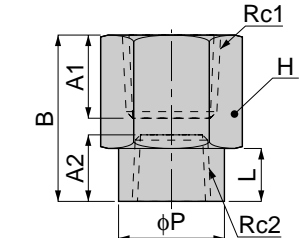

Model	Rc1	Rc2	A1	A2	B	L	φP	H	Mass (g)	Orifice (φmm)	Eff. a. (mm ²)	unit:mm
PFF 01-M5	Rc1/8	M5×0.8	8	5	17	7	8	14	11.5	3	5.3	1
PFF 02-01	Rc1/4	Rc1/8	11	8	21	8	14	17	22.5	6.5	22.1	
PFF 03-01	Rc3/8	Rc1/8	12	8	22	8	14	21	31.5	6.5	28.8	
PFF 03-02		Rc1/4		11	25	11	17		35.5	9	37.7	
PFF 04-02	Rc1/2	Rc1/4	15	11	30	11	17	24	51.5	9	50.8	
PFF 04-03		Rc3/8		12	33	14	21		59	12	89.8	

unit:inch

MODEL	NPT1	NPT2	A1	A2	B	H	Weight (g)	Orifice φMM	Eff.a. mm ²	Cv
PFF N1-U10U	1/8	10-32UNF	0.31	0.14	0.67	9/16	11.7	3.0	5.3	0.29
PFF N2-N1U	1/4	1/8	0.43	0.31	0.83	11/16	22.2	6.5	22.1	1.20
PFF N3-N1U	3/8	1/8	0.47	0.31	0.87	7/8	34.1	6.5	28.8	1.56
PFF N3-N2U	1/4	1/4	0.47	0.43	0.98	7/8	38.0	9.0	37.7	2.04
PFF N4-N2U	1/2	1/4	0.59	0.43	1.18	1.00	58.4	9.0	50.8	2.75
PFF N4-N3U	1/2	3/8	0.59	0.47	1.30	1.00	66.3	12.0	89.8	4.87



PTJ

PT Jack

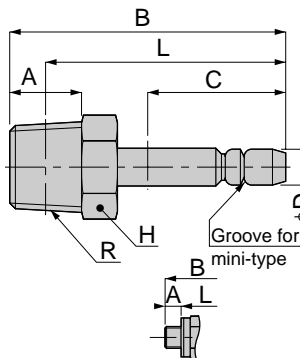

Metric thread type

Model	Tube dia. φD	R	A	B	L	C	H	Mass (g)	Orifice (φmm)	Eff. a. (mm ²)	unit:mm
PTJ 4-M5	4	M5×0.8	3	27.5	24.5	15	8	4	1.8	2.2	1
PTJ 4-01		R1/8	8	30.5	26.5		10	8	2.2	3.8	
PTJ 6-M5	6	M5×0.8	3	30.5	28	17	8	8	1.8	2.2	
PTJ 6-01		R1/8	8	32.5	28.5		10	8.5	4	11.1	
PTJ 6-02		R1/4	11	36.5	30.5		14	19			
PTJ 8-01	8	R1/8	8	34	30	18	10	12	6	17.8	
PTJ 8-02		R1/4	11	37	31		14	18		23.1	
PTJ 8-03		R3/8	12	39	32.5		17	31.5		24.2	
PTJ 10-03		R3/8	12	41.5	35		20	17		30.5	8

※Groove for mini-type is not constructed.



PIJ

Nipple

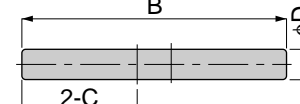

Model	φD	B	C	Mass (g)	Orifice (φmm)	Eff. a. (mm ²)	unit:mm
PIJ 4	4	35	15	0.5	2.5	4.2	1
PIJ 6	6	38	17	0.5	4	11.2	
PIJ 8	8	41.5	18	1	6	24.2	
PIJ 10	10	46	20	1.5	7.5	37.1	
PIJ 12	12	53	23.5	3	9	56	
PIJ 16	16	55.5	24	4	11	113.7	