

PHT

Triple Universal Elbow

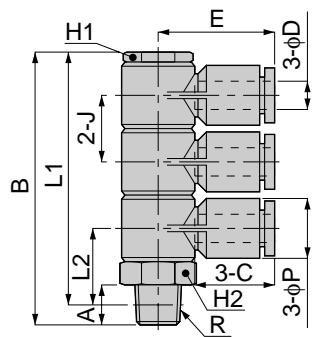

Model	Tube dia. φD	R	A	B	L1	L2	φP	C	J	E	H1	H2	Mass (g)	Orifice (φmm)	Eff. a. (mm ²)
PHT 4-01	4	R1/8	8	57	53	16	10	15	14	22.5	14	14	36.5	3	4.7
PHT 4-02		R1/4	11	60	54	17						14	39.5		4.3
PHT 4-03		R3/8	12	62	55.5	18.5						17	49.5		4.2
PHT 6-01	6	R1/8	8	57	53	16	12.5	17	14	24.5	14	14	39	4.6	9.6
PHT 6-02		R1/4	11	60	54	17						14	42		9.7
PHT 6-03		R3/8	12	62	55.5	18.5						17	52.5		9.5
PHT 8-01	8	R1/8	8	61	57	17.5	14.5	18.5	15	28.5	17	17	57.5	5.1	14.3
PHT 8-02		R1/4	11	64	58	18.5						17	60.5		15.5
PHT 8-03		R3/8	12	65	58.5	19						17	65		15.1
PHT 8-04		R1/2	15	70	62	22.5						22	88.5		15.1
PHT 10-02	10	R1/4	11	75.5	69.5	22	18	20.5	18	33	22	22	107.5	6.5	21.9
PHT 10-03		R3/8	12	76.5	70	22.5						22	114		22.7
PHT 10-04		R1/2	15	79.5	71.5	24						22	121.5		22.6
PHT 12-02	12	R1/4	11	88	82	26.5	21	23.5	21	38.5	27	27	181	7.7	30.3
PHT 12-03		R3/8	12	89	82.5	27						27	187		30.6
PHT 12-04		R1/2	15	92	84	28.5						27	195		31.5
PHT 1/4-01	1/4	R1/8	8	57	53	16	12.5	17	14	24.5	14	14	39	4.6	9.8
PHT 1/4-02		R1/4	11	60	54	17						14	42		10
PHT 1/4-03		R3/8	12	62	55.5	18.5						17	52.5		9.8
PHT 5/16-02	5/16	R1/4	11	64	58	18.5	14.5	18.5	15	28.5	17	17	60.5	5.1	15.5
PHT 5/16-03		R3/8	12	65	58.5	19						17	65		15.1
PHT 5/16-04		R1/2	15	70	62	22.5						22	88.5		15.1
PHT 3/8-02	3/8	R1/4	11	75.5	69.5	22	18	20.5	18	33	22	22	108	6.5	20.9
PHT 3/8-03		R3/8	12	76.5	70	22.5						22	114		22
PHT 3/8-04		R1/2	15	79.5	71.5	24						22	121.5		22.3

unit:mm

unit:inch

MODEL	Tube dia. φD	NPT	A	B	L	φP	C	J	E	H1	H2	Weight (g)	Orifice φMM	Eff.a. mm ²	Cv
PHT 5/32-N1U	5/32	1/8	0.31	2.24	2.09	0.39	0.59	0.55	0.89	0.55	9/16	36.6	3.0	4.7	0.25
PHT 5/32-N2U	5/32	1/4	0.43	2.36	2.13	0.39	0.59	0.55	0.89	0.55	9/16	39.5	3.0	4.3	0.23
PHT 1/4-N1U	1/4	8/1	0.31	2.24	2.09	0.49	0.67	0.55	0.96	0.55	9/16	39.0	4.6	9.8	0.53
PHT 1/4-N2U	1/4	4/1	0.43	2.36	2.13	0.49	0.67	0.55	0.96	0.55	9/16	41.7	4.6	10.0	0.54
PHT 1/4-N3U	1/4	3/8	0.47	2.44	2.13	0.49	0.67	0.55	0.96	0.55	11/16	52.9	4.6	9.8	0.53
PHT 5/16-N2U	5/16	1/4	0.43	2.52	2.19	0.57	0.71	0.59	1.12	0.67	11/16	61.4	6.0	15.5	0.84
PHT 5/16-N3U	5/16	3/8	0.47	2.56	2.24	0.57	0.71	0.59	1.12	0.67	11/16	66.9	6.0	15.1	0.82
PHT 5/16-N4U	5/16	1/2	0.59	2.76	2.28	0.57	0.71	0.59	1.12	0.67	7/8	88.5	6.0	15.1	0.82
PHT 3/8-N2U	3/8	4/1	0.43	2.97	2.74	0.71	0.79	0.71	1.30	0.87	7/8	108.0	7.5	21.1	1.14
PHT 3/8-N3U	3/8	3/8	0.47	3.01	2.76	0.71	0.79	0.71	1.30	0.87	7/8	113.4	7.5	21.6	1.17
PHT 3/8-N4U	3/8	1/2	0.59	3.13	2.81	0.71	0.79	0.71	1.30	0.87	7/8	121.3	7.5	21.5	1.17

PAW

Double Branch A

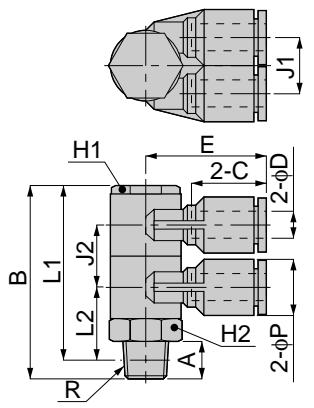

Model	Tube dia. φD	R	A	B	L1	L2	φP	C	J1	J2	E	H1	H2	Mass (g)	Orifice (φmm)	Eff. a. (mm ²)
PAW 4-01	4	R1/8	8	43	39	16	10	15	10	14	22.5	14	14	33	3	4.3
PAW 4-02		R1/4	11	46	40	17							17	36		4.2
PAW 4-03		R3/8	12	48	41.5	18.5							17	46		4.2
PAW 6-01	6	R1/8	8	43	39	16	12.5	17	12	14	26.5	14	14	37.5	4.6	6.9
PAW 6-02		R1/4	11	46	40	17							14	40		7
PAW 6-03		R3/8	12	48	41.5	18.5							17	50.5		6.9
PAW 8-01	8	R1/8	8	46	42	17.5	14.5	18.5	14	15	29.5	17	17	53.5	5.1	12.4
PAW 8-02		R1/4	11	49	43	18.5							17	57		13.9
PAW 8-03		R3/8	12	50	43.5	19							17	62		14
PAW 8-04		R1/2	15	55	47	22.5							22	84.5		14
PAW 10-02	10	R1/4	11	57.5	51.5	22	17.5	20.5	17	18	34	22	22	98	6.5	21.6
PAW 10-03		R3/8	12	58.5	52	22.5							22	104.5		21.3
PAW 10-04		R1/2	15	61.5	53.5	24							22	112.5		22.2
PAW 12-02	12	R1/4	11	67	61	26.5	21	23.5	20	21	37.5	27	27	163.5	7.7	43.2
PAW 12-03		R3/8	12	68	61.5	27							27	169		44.4
PAW 12-04		R1/2	15	71	63	28.5							27	177		45.4
PAW 1/4-01	1/4	R1/8	8	43	39	16	12.5	17	12	14	26.5	14	14	37.5	4.6	7
PAW 1/4-02		R1/4	11	46	40	17							14	40		7.1
PAW 1/4-03		R3/8	12	48	41.5	18.5							17	50.5		7.1
PAW 5/16-02	5/16	R1/4	11	49	43	18.5	14.5	18.5	14	15	29.5	17	17	57	5.1	13.9
PAW 5/16-03		R3/8	12	50	43.5	19							17	62		14
PAW 5/16-04		R1/2	15	55	47	22.5							22	84.5		14
PAW 3/8-02	3/8	R1/4	11	57.5	51.5	22	17.5	20.5	17	18	34	22	22	99	6.5	20.4
PAW 3/8-03		R3/8	12	58.5	52	22.5							22	104.5		21.1
PAW 3/8-04		R1/2	15	61.5	53.5	24							22	112.5		20.7

unit:mm

unit:inch

MODEL	Tube dia. φ	NPT	A	B	L	φP	C	J1	J2	E	H1	H2	Weight (G)	Orifice φMM	Eff.a. mm ²	CV
PAW5/32-N1U	5/32	NPT1/8	0.31	1.69	1.54	0.39	0.59	0.39	0.55	0.87	0.55	9/16	33.4	3	4.3	0.23
PAW5/32-N2U	5/32	NPT1/4	0.43	1.81	1.57	0.39	0.59	0.39	0.55	0.87	0.55	9/16	36.3	3	4.3	0.23
PAW1/4-N1U	1/4	NPT1/8	0.31	1.69	1.54	0.49	0.67	0.47	0.55	1.04	0.55	9/16	37.0	5	7.0	0.38
PAW1/4-N2U	1/4	NPT1/4	0.43	1.81	1.57	0.49	0.67	0.47	0.55	1.04	0.55	9/16	39.7	5	7.0	0.38
PAW1/4-N3U	1/4	NPT3/8	0.47	1.89	1.63	0.49	0.67	0.47	0.55	1.04	0.55	11/16	50.6	5	7.1	0.38
PAW5/16-N2U	5/16	NPT1/4	0.43	1.93	1.69	0.57	0.73	0.55	0.59	1.16	0.67	11/16	56.8	6	13.9	0.75
PAW5/16-N3U	5/16	NPT3/8	0.47	1.97	1.71	0.57	0.73	0.55	0.59	1.16	0.67	11/16	62.7	6	14.0	0.76
PAW5/16-N4U	5/16	NPT1/2	0.59	2.17	1.83	0.57	0.73	0.55	0.59	1.16	0.67	7/8	84.6	6	14.0	0.76
PAW3/8-N2U	3/8	NPT1/4	0.43	2.26	2.03	0.69	0.81	0.67	0.71	1.34	0.87	7/8	99.6	8	20.4	1.11
PAW3/8-N3U	3/8	NPT3/8	0.47	2.30	2.05	0.69	0.81	0.67	0.71	1.34	0.87	7/8	104.8	8	21.1	1.14
PAW3/8-N4U	3/8	NPT1/2	0.59	2.42	2.11	0.69	0.81	0.67	0.71	1.34	0.87	7/8	112.4	8	20.7	1.12